



WILDWOOD

January 24, 2023

MEMORANDUM

To: Planning and Parks Committee Members

From: Department of Planning and Parks

Re: **Community Park Projects – Safety Enhancements (Ward One)**

Cc: The Honorable James R. Bowlin, Mayor
Steve Cross, City Administrator
Rick Brown, P.E. and P.T.O.E., Director of Public Works
Melanie Rippetoe, Assistant Director of Planning and Parks
Travis Newberry, Senior Planner
Kristin Naeger, Superintendent of Parks and Recreation
Stacy Chanski, Recreation Specialist

BACKGROUND >>> The Department of Planning has been coordinating the efforts to address the design situation that had been identified relative to the tree wells that are located in the playground area of Community Park. This design situation relates to the depth of the tree well areas and the fall potential associated with them. Originally, the Department had been provided several options from a park designer that has been involved in many projects within Wildwood and also the major contractor that had done work for many years upon the community's park properties. All of these options had impacts on the character of this very special playground area.

To this end, the Department did not support these options and sought a solution that started inside the tree wells, which would lead to an approach that maintains the character of the overall playground area. The outcome of this effort was a plan that is attached, which treats the depth of them by adding/placing material in them to reduce the vertical distance, while also making them better for overall use and play. Improving these four (4) tree wells for play areas does require the following steps:

1. Tree Well "A" – add six (6) to eight (8) inches of hardwood mulch.
2. Tree Well "B" – raise area inlet a height of eighteen (18) inches, along with adding additional soil and mulch to reduce depth of the well area.
3. Tree Well "C" – construct a deck surface over the area of the tree well, with a slight step down into it, while protecting the tree by providing a cutout with the decking boards.

4. Tree Well "D" – fill southern end of this tree well area and taper toward the north end of it, which is not characterized by the depth consideration.

Other than the deck area, which is a relatively small size, the primary work is placing soil, hardwood mulch, and a few boulders for steps, all leading to the new play surfaces within the tree well areas. This work is relatively inexpensive. The decking will have more cost, but certainly commensurate with the railing system that was the first option in this regard.

SUMMARY AND NEXT STEPS >>> The Department is presenting this approach that has been developed for the Committee's input and direction. With the Committee's support for these options, the Department would like to proceed with three (3) of the four (4) well areas and seek a bid for the cost of the decking specific to the fourth area at Community Park. Once bids have been obtained, they would be presented to the Committee for recommendation.

CONTACT INFORMATION >>> If any of the Members should have questions or comments before tonight's meeting, please feel free to contact any of the Department of Planning with them at (636) 458-0440. A presentation is planned on this matter at tonight's meeting. Thank you for your review and input on this information.

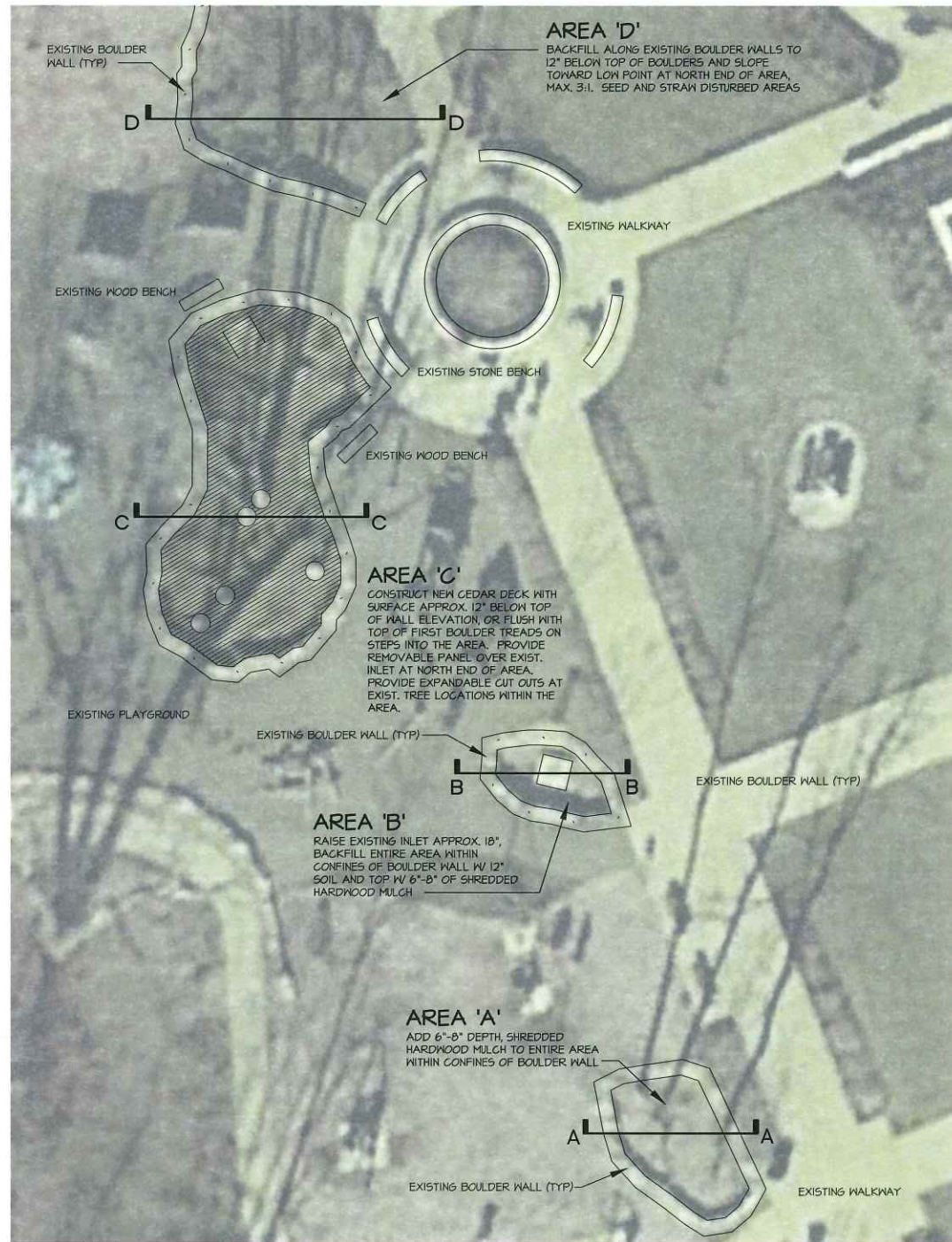

PLAYGROUND RAILING PLAN

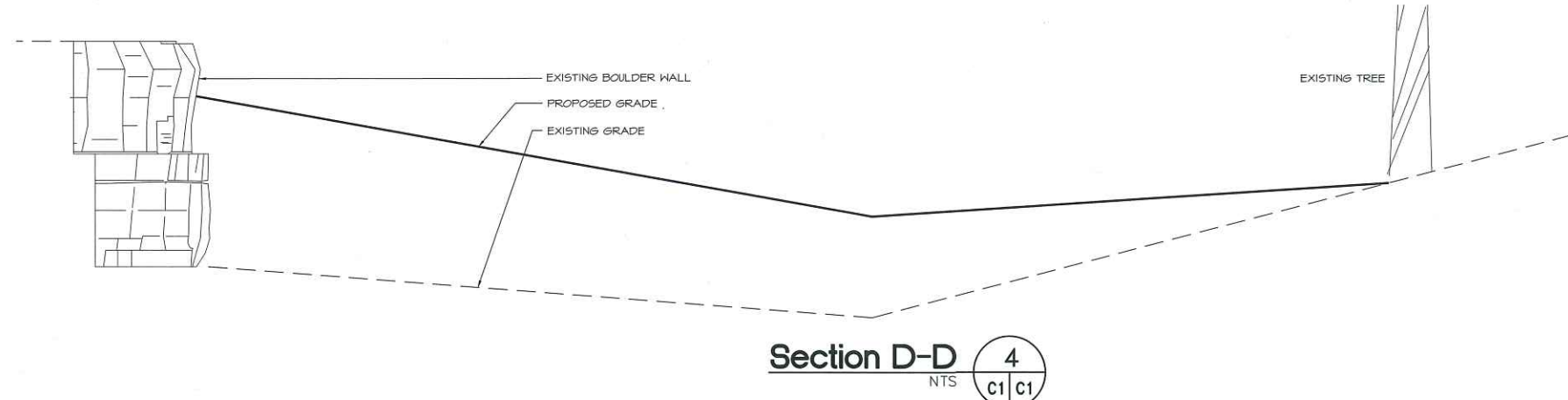
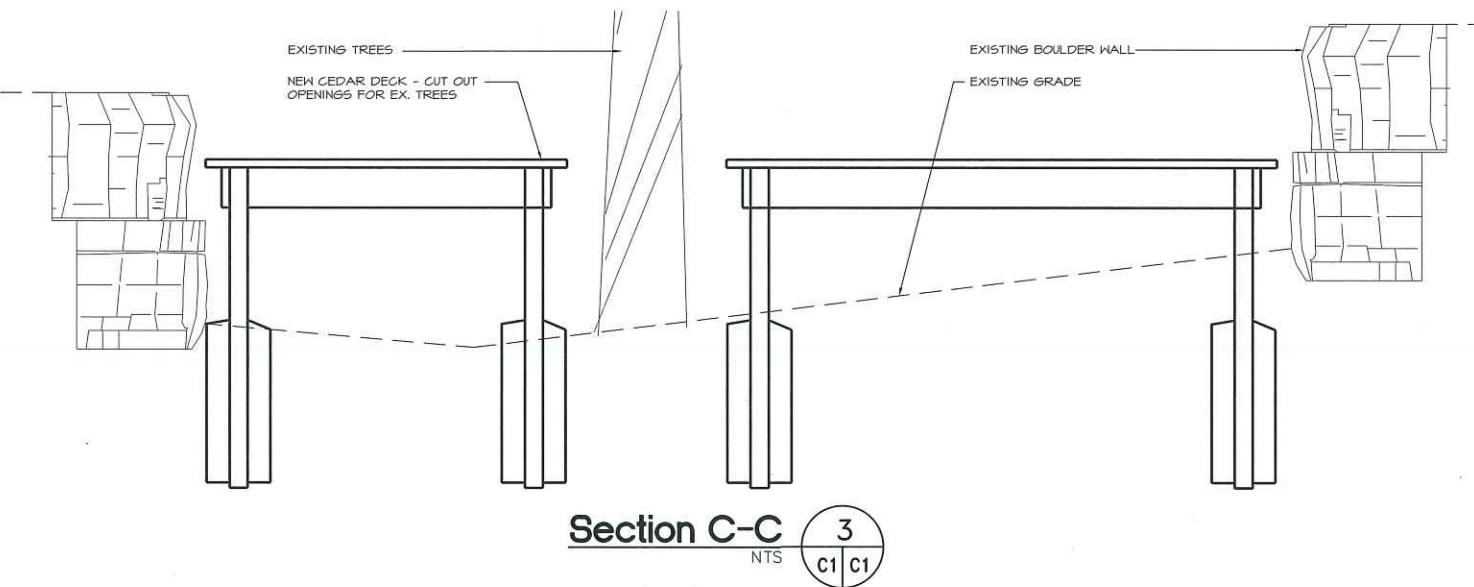
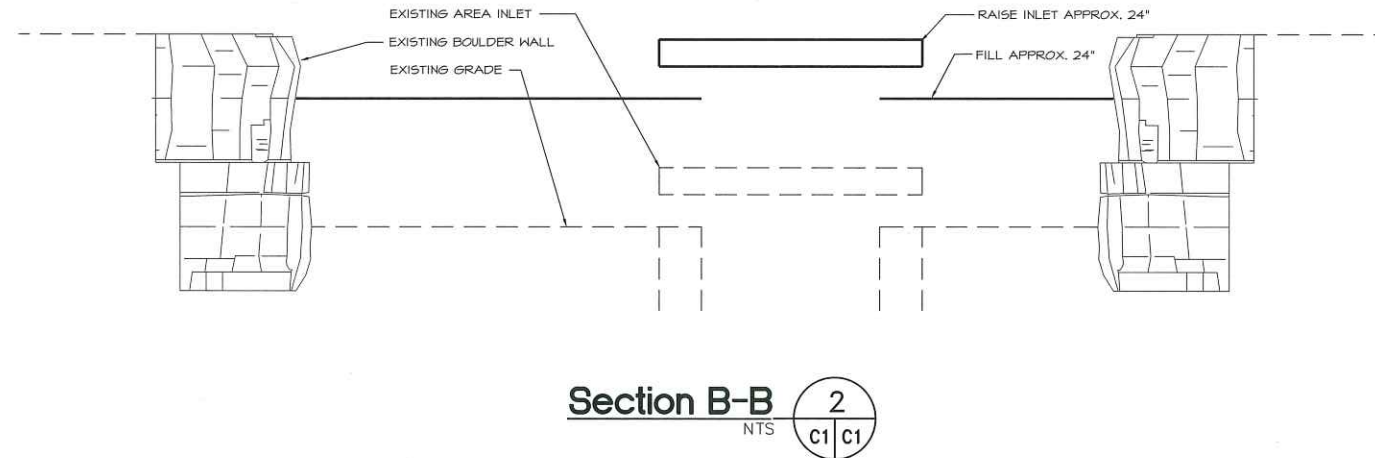
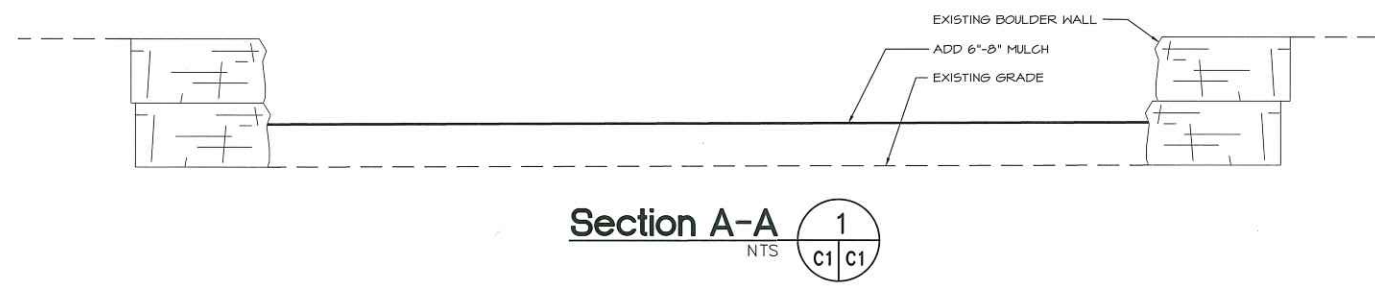

LAND PLANNING
RECREATION PLANNING AND DESIGN
LANDSCAPE ARCHITECTURE

Terraspec

11426 Gravois Road Suite 102
ST. LOUIS, MO 63126
(314) 984-8211

REVIEW

**Wildwood Comm. Park
Misc. Improvements**

Community Park
Wildwood, Missouri 63040

OWNER
City of Wildwood
16860 Main Street
Wildwood, MO 63040
Ph: 636-458-0440
Fax: (636) 458-6969

SHEET TITLE
**TREE WELL
IMPROVEMENTS**

JOB NUMBER
22-026.00

DATE 12-17-22 DRAWN BY KJK
REVISION

SHEET NUMBER
C1